



Quality Engineered Ball Valves



B3 SERIES



Two-Piece WCB and CF8M Body Screwed End Ball

- Blow-out proof stem
- 316 SS Ball and Stem
- 3000 PSI Sizes - 1/4" - 1 1/2" Full Port
- 3000 PSI Sizes - 2" Regular Port
- Fire Tested and Certified to API 607 4th Addition
- Standard Locking Handle
- Actuator Mounting Pad
- Delrin Seats Standard
- Conforms to NACE MR-01-75 Standard
- Ball Includes Pressure Equalization Hole to Prevent Trapped Pressure in Body Cavity

Assembly Base Numbers

SIZE	1/4"	1/2"	3/4"	1"	1 1/2"	2"
Max. Working Pressure	3000 CWP					
Weight - LBS	1.61	1.61	2.93	5.16	10.70	11.29
Assembly Base No.	83025	83050	83075	83100	83150	83200

Materials List

Part	Material
	<i>Full Bore / Reduced Bore</i>
Body / Adapter	A216 WCB / AISI 1018
Ball / Stem	316 SS
Seats	Delrin
Seals	Teflon / Graphite
Body / Adapter	A351 CF8M
Ball / Stem	316 SS
Seats	Delrin
Seals	Teflon / Graphite

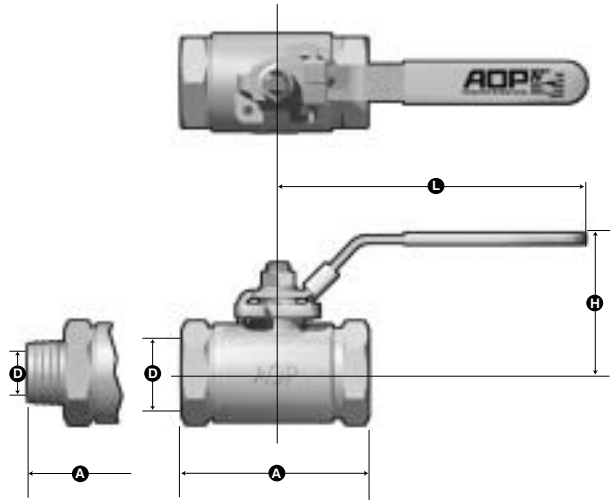

Dimensions

Size (mm/in)	8 1/4"	15 1/2"	20 3/4"	25 1"	40 1 1/2"	50 2"
D Bore Sizes FXF	6.4	12.7	19.1	25.4	38.1	38.1
	.25	.50	.75	1.00	1.50	1.50
D Bore Sizes MXF	6.4	12.7	15.7	19.1	--	--
	.25	.50	.62	.75	--	--
A End to End FXF	76.2	101.6	108.0	114.3	133.4	158.8
	3.00	4.00	4.25	4.50	5.25	6.25
A End to End MXF	95.2	108.0	119.1	133.4	--	--
	3.75	4.25	4.69	5.25	--	--
L Length of Lever	127.0	127.0	148.1	205.7	254.0	254.0
	5.00	5.00	5.83	8.10	10.00	10.00
H Center to Lever	48.8	48.8	65.0	87.6	104.9	104.9
	1.92	1.92	2.56	3.45	4.13	4.13
CV	6	15	30	60	130	120

B6 SERIES



Two-Piece WCB and CF8M Body Screwed End Ball

- Blow-out proof stem
- 316 SS Ball and Stem
- 6000 PSI Sizes - 1/4" - 1 1/2" Full Port
- 6000 PSI Sizes - 2" Regular Port
- Fire Tested and Certified to API 607 4th Addition
- Standard Locking Handle
- Actuator Mounting Pad
- Delrin Seats Standard
- Conforms to NACE MR-01-75 Standard
- Ball Includes Pressure Equalization Hole to Prevent Trapped Pressure in Body Cavity

Assembly Base Numbers

SIZE	1/4"	1/2"	3/4"	1"	1 1/2"	2"
Max. Working Pressure	6000 CWP					
Weight - LBS	1.61	1.63	3.37	6.63	14.20	15.58
Assembly Base No.	86025	86050	86075	86100	86150	86200

Materials List

Part	Material
	<i>Full Bore / Reduced Bore</i>
Body / Adapter	<i>A216 WCB / AISI 1018</i>
Ball / Stem	<i>316 SS</i>
Seats	<i>Delrin</i>
Seals	<i>Teflon / Graphite</i>
Body / Adapter	<i>A351 CF8M</i>
Ball / Stem	<i>316 SS</i>
Seats	<i>Delrin</i>
Seals	<i>Teflon / Graphite</i>

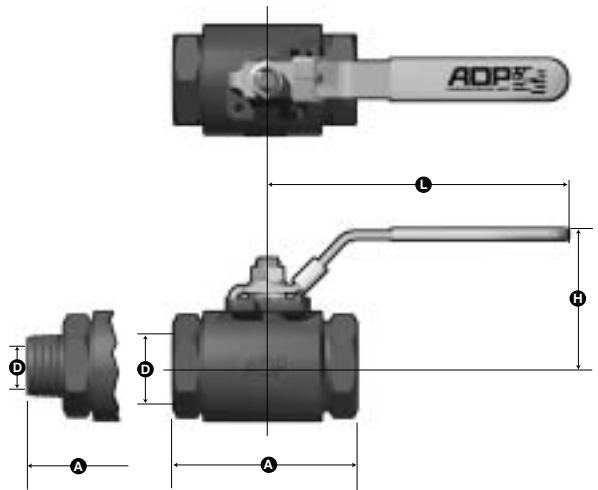

Dimensions

Size (mm/in)	8 1/4"	15 1/2"	20 3/4"	25 1"	40 1 1/2"	50 2"
D Bore Sizes FXF	6.4	12.7	19.1	25.4	38.1	38.1
	.25	.50	.75	1.00	1.50	1.50
D Bore Sizes MXF	6.4	12.7	15.7	19.1	--	--
	.25	.50	.62	.75	--	--
A End to End FXF	76.2	101.6	108.0	114.3	133.4	158.8
	3.00	4.00	4.25	4.50	5.25	6.25
A End to End MXF	95.2	108.0	119.1	133.4	--	--
	3.75	4.25	4.69	5.25	--	--
L Length of Lever	127.0	127.0	148.1	205.7	254.0	254.0
	5.00	5.00	5.83	8.10	10.00	10.00
H Center to Lever	48.8	48.8	65.0	87.6	104.9	104.9
	1.92	1.92	2.56	3.45	4.13	4.13
CV	6	15	30	60	130	120

BSS SERIES

Seal Welded CF8M Body Full Port Screwed End Ball Valve

- Seal Welded CF8M body full port screwed ends
- 316SS Ball & Stem
- Blow-out proof stem / Floating ball
- Adjustable packing nut
- Locking lever handle
- Actuator mounting pad
- 2000 PSI W.O.G. ¼" - 2"
- 1000 PSI W.O.G. 2½" - 3"
- 150 PSI saturated steam
- Threads conform to ANSI B1.20.1, BS21, DIN259 / 2999
- Conforms to NACE MR-01-75 specifications
- Fire test & certified to API 607 4th Edition



Assembly Base Numbers

SIZE	1/4"	3/8"	1/2"	3/4"	1"	1 1/4"	1 1/2"	2"	2 1/2"	3"
Max. Working Pressure	2000								1000	
Weight - LBS	.6	.6	.8	1.4	2.4	2.7	4.5	6.1	12.5	17.75
Assembly Base No.	9025	9038	9050	9075	9100	9125	9150	9200	9250	9300
316SS Trim - Thd	-222N	-222N	-222N	-222N	-222N	-222N	-222N	-222N	-222N	-222N

Materials List

Part	Material
Handle Grip	Vinyl
Handle	A276 304SS
Locking Device	A276 304SS
Handle Nut	A276 304SS
Stem Washer	A276 304SS
Packing	A276 304SS
Stem	A276 316SS
Packing	PTFE
Thrust Washer	Reinforced Teflon 15%GF
Seat	Reinforced Teflon 15%GF
Ball	A276 316SS
Tailpiece	CF8M
Body	CF8M
Body Seal	PTFE

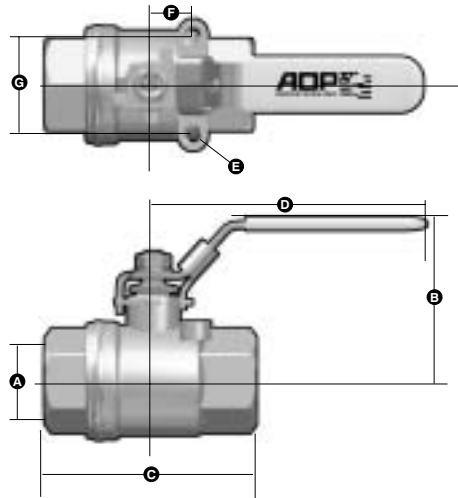

Dimensions

Size (mm/in)	8 1/4"	10 3/8"	15 1/2"	20 3/4"	25 1"	32 1 1/4"	40 1 1/2"	50 2"	65 2 1/2"	80 3"
A	9.6	9.6	12.7	20	25	32	38	50.8	65	80
	0.375	0.375	0.500	0.787	0.984	1.260	1.496	2.000	2.559	3.150
B	54	54	57	65.5	69.5	82.5	88	105	138	148
	2.13	2.13	2.24	2.58	2.74	3.25	3.46	4.13	5.43	5.83
C	57.6	57.6	62	72.5	86	94	116	134	164	180
	2.264	2.264	2.441	2.854	3.386	3.700	4.567	5.267	6.456	7.086
D	103.5	103.5	103.5	125	125	158	158	181	252	252
	4.07	4.07	4.07	4.92	4.92	6.22	6.22	7.13	9.92	9.92
E			M6	M6	M6	M8	M8	M8		
F	12.7	12.7	12.7	22.1	22.1	23.62	23.62	23.62	70	70
	0.50	0.50	0.50	0.87	0.87	0.93	0.93	0.93	2.75	2.75
G	28.45	28.45	28.45	34.8	34.8	50.5	54	60.3	73	73
	1.12	1.12	1.12	1.37	1.37	2.00	2.125	2.375	2.875	2.875
Cv	6	9	14	30	60	104	150	290	500	720

BN SERIES

Two-Piece WCB and CF8M Body Port Screwed End Ball



- Large port screwed ends 2 piece carbon steel body
- 316SS Ball & Stem
- Blow-out proof stem
- Adjustable packing gland
- Locking lever handle
- Actuator mounting pad
- 2000 PSI W.O.G. ¼" - 2"
- 150 PSI saturated steam
- Threads conform to ANSI B1.20.1, BS21, DIN259 / 2999
- Conforms to NACE MR-01-75 specifications

Assembly Base Numbers

SIZE	1/4"	3/8"	1/2"	3/4"	1"	1 1/4"	1 1/2"	2"
Max. Working Pressure	2000							
Weight - LBS	.6	.6	.8	1.4	2.4	2.7	4.5	6.1
Assembly Base No.	9025	9038	9050	9075	9100	9125	9150	9200
316SS Trim - Thd	-122N	-122N	-122N	-122N	-122N	-122N	-122N	-122N

Materials List

Part	Material
Handle Grip	Vinyl
Handle	Plated CS
Handle Nut	Plated CS
Gland	A108 CS
Stem	A276 316SS
Packing	PTFE
Thrust Washer	Reinforced Teflon 15%GF
Seat	Reinforced Teflon 15%GF
Ball	A276 316SS
Tailpiece	A216 WCB
Body	A216 WCB
Body Seal	PTFE

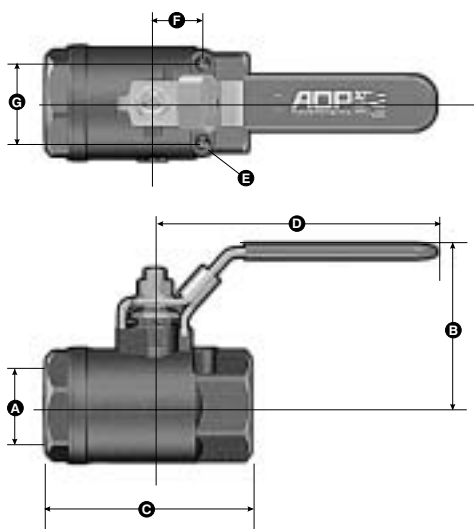

Dimensions

Size (mm/in)	8 1/4"	10 3/8"	15 1/2"	20 3/4"	25 1"	32 1 1/4"	40 1 1/2"	50 2"
A	11	12.5	12.5	17.5	22	25	31.8	38
B	.433	0.492	0.492	0.689	0.866	0.984	1.252	1.490
C	102	102	102	129	129	153.5	153.5	188
D	4.015	4.015	4.015	5.078	5.078	6.043	6.043	7.401
E	58.5	58.5	61.5	79.5	88.5	102	111	137
F	2.303	2.303	2.421	3.130	3.484	4.015	4.370	5.394
G	53	53	53	64.5	67	84	89.5	94.5
Cv	2.086	2.086	2.086	2.539	2.637	3.307	3.523	3.720
	M6	M6	M6	M6	M6	M8	M8	M8
	12.7	12.7	12.7	22.1	22.1	50	50	50
	0.5	0.5	0.5	0.87	0.87	1.968	1.968	1.968
	28.45	28.45	28.45	34.8	34.8			
	1.12	1.12	28.45	1.37	1.37			
	6.8	6.8	9.8	25	35	47	81	105

BU SERIES



One-Piece Carbon Steel Reduce Port Screwed End Ball Valve

- One piece carbon steel body reduce port screwed ends
- 304SS Ball & Stem
- Blow-out proof stem
- 2000 PSI W.O.G. ¼" - 2"
- 150 PSI saturated steam
- Threads conform to ANSI B1.20.1, BS21, DIN259 / 2999
- Conforms to NACE MR-01-75 specifications

Assembly Base Numbers

SIZE	1/4"	3/8"	1/2"	3/4"	1"	1 1/4"	1 1/2"	2"
Max. Working Pressure	2000							
Weight - LBS	.5	.5	.6	.8	1.4	2.4	3.1	5.0
Assembly Base No.	9025	9038	9050	9075	9100	9125	9150	9200
304SS Trim - Thd	-121N	-121N	-121N	-121N	-121N	-121N	-121N	-121N

Materials List

Part	Material
Handle Grip	Vinyl
Handle	Plated CS
Handle Nut	Plated CS
Packing Bushing	A276 304SS
Packing	PTFE
Stem	A276 304SS
Thrust Washer	Reinforced Teflon 15%GF
Seat Retainer	A108 CS GR1020
Seat	Reinforced Teflon 15%GF
Gasket	PTFE
Ball	A276 304SS
Body	CS A108 GR1020
Stem Washer	A276 304SS
Spring Washer	A276 304SS
Bellevill Washer	302SS

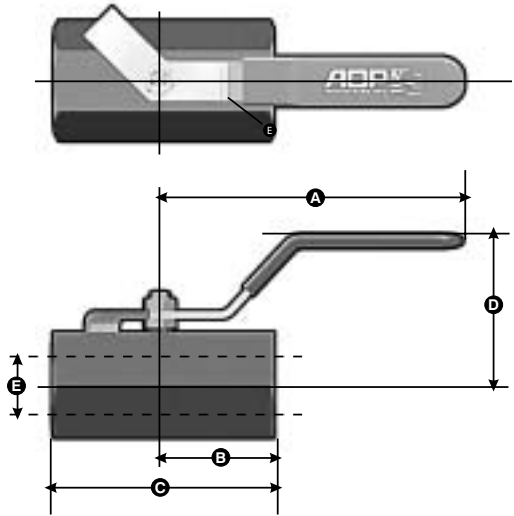

Dimensions

Size (mm/in)	8 1/4"	10 3/8"	15 1/2"	20 3/4"	25 1"	32 1 1/4"	40 1 1/2"	50 2"
A	66.3	80	109.47	109.47	122	147.5	147.5	154
	2.61	3.15	4.31	4.31	4.8	5.81	5.81	6.06
B	23.9	26.05	32.95	37.25	44.5	48.6	52.55	57.7
	0.94	1.03	1.3	1.47	1.75	1.91	2.07	2.27
C	43.1	47.35	61.72	69.85	85.73	93.67	101.6	114.3
	1.7	1.86	2.43	2.75	3.38	3.69	4	4.5
D	29.1	33.35	54.41	59.15	62.15	68	69	81.9
	1.15	1.31	2.14	2.33	2.45	2.68	2.72	3.22
E	4.6	6.8	9.2	12.5	16	20	24.7	32
	0.18	0.27	0.36	0.49	0.63	0.79	0.97	1.26
Cv	1.5	3.5	4.5	8	15	33	40	70

BZ SERIES

Two-Piece Bronze Large Port Screwed End Ball Valve

- Heavy Duty Cast Bronze Construction / Steel Handle
- Blow-out Proof Steel
- Adjustable Packing Gland
- Brass w/Hard Chrome Plated Ball
- 600 PSI W.O.G. ¼" - 2"
- 400 PSI W.O.G. 2½" - 4"



Assembly Base Numbers

SIZE	1/4"	3/8"	1/2"	3/4"	1"	1 1/4"	1 1/2"	2"	2 1/2"	3"	4"	
Max. Working Pressure	600								400			
Weight - LBS	.5	.5	.6	.9	1.4	2.4	3.5	5.0	8.6	10.6	13.5	
Assembly Base No.	9025	9038	9050	9075	9100	9125	9150	9200	9250	9300	9400	
316SS Trim - Thd	-331	-331	-331	-331	-331	-331	-331	-331	-331	-331	-331	

Materials List

Part	Material
Body	Cast Bronze
Tailpiece (1/4" - 3/4")	Brass Hex Rod
Tailpiece (1" - 4")	Cast Bronze
Ball	Brass w/Hard Chrome Plating
Seal	Reinforced PTFE, 15% Glass Filled
Stem	Brass Round Rod
Washer	Reinforced PTFE, 15% Glass Filled
Packing	PTFE
Packing Nut	Brass Hex Rod
Handle	Steel w/Zinc Coating
Hand Grip	Vinyl
Handle Nut	Steel w/Zinc Coating

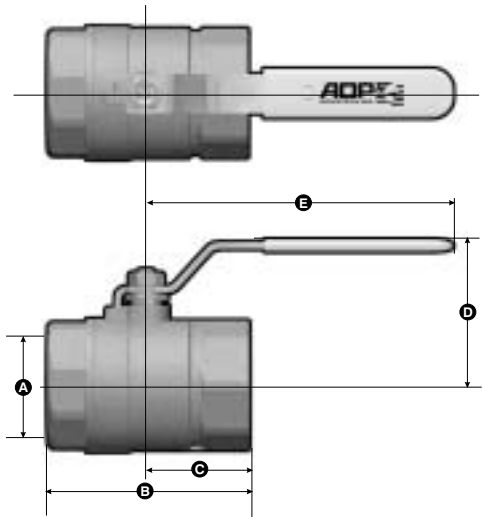

Dimensions

Size (mm/in)	8 1/4"	10 3/8"	15 1/2"	20 3/4"	25 1"	32 1 1/4"	40 1 1/2"	50 2"	80 3"	100 4"
A	9.652	9.652	12.7	17.5	22.6	26.9	33.3	39.6	68.1	76.2
	0.38	0.38	0.50	0.69	0.89	1.06	1.31	1.56	2.68	3
B	50	50	55.6	64.3	80.8	88.9	100.8	109.2	156.5	177.8
	1.97	1.97	2.19	2.53	3.18	3.50	3.97	4.30	6.16	7
C	24.9	24.9	27.9	33	40.4	44.4	50	54.6	78.7	88.9
	0.98	0.98	1.10	1.30	1.59	1.75	1.97	2.15	3.10	3.5
D	45.7	45.7	47.7	54.3	58.4	68.8	73.7	78.5	106.4	114.3
	1.80	1.80	1.88	2.14	2.30	2.71	2.90	3.09	4.19	4.5
E	96.8	96.8	96.8	117.3	117.3	160.3	160.3	182.6	182.6	179.4
	3.81	3.81	3.81	4.62	4.62	6.31	6.31	7.19	7.19	7 ²⁹ / ₃₂
Cv	7	7	10	25	40	52	90	115	440	524

Pressure Temperature Ratings

B3 SERIES

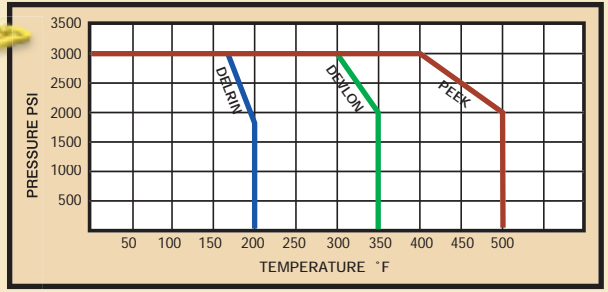

B6 SERIES

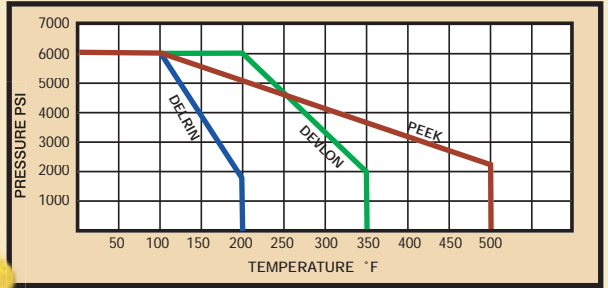

BSS SERIES

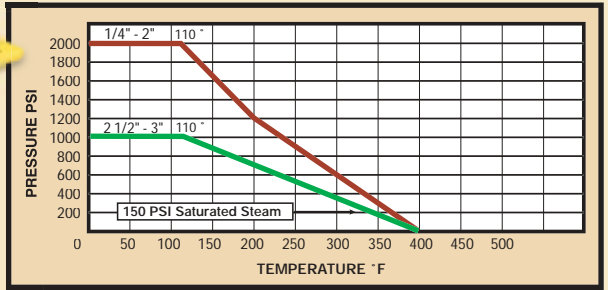

BN SERIES

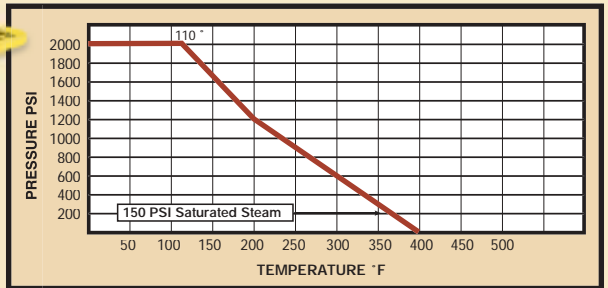

BU SERIES

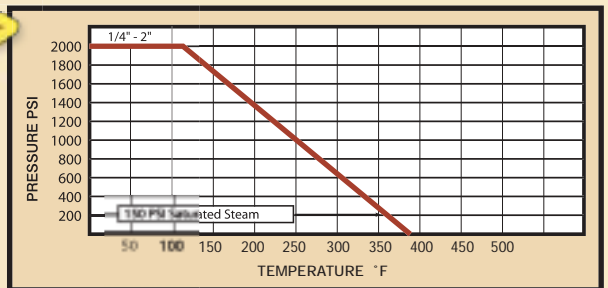
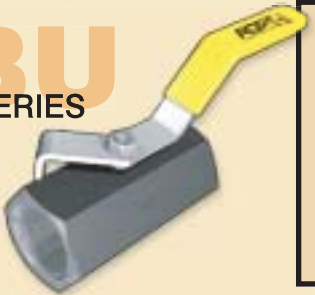

BZ SERIES

